

234 Bowerham Road, Lancaster, Lancashire, LA1 4JP



£145 Per Week



Head Office: 83 Bowerham Road Lancaster LA1 4AQ
T 01524 548888 E enquiries@mightyhouse.co.uk W www.mightyhouse.co.uk



Mighty House is a trading name of P&PC Surveyors Limited. Registered Office: 70 Daisy Hill, Dewsbury, WF13 1LS. Company no: 06498054

***Beautiful 12 Bed Property
Available for the 2023/24 academic
year***

This is a substantial, 12 bedroom 12
bathroom property that certainly has
the 'wow' factor.

Incredibly stylish, modern and
boutique feeling this property has
had no expense spared in terms of
finish.

Located in the highly desirable
student area, Bowerham this
property is great for a large group!

£145 for Standard rooms and £160
for Kitchenette rooms.

The ground floor consists of 6
bedrooms of which have have
kitchenettes and ensuite shower
rooms and 1 further bedroom that
has an ensuite shower room.

The first floor consists of 2
bedrooms with kitchenettes and
ensuites, 3 bedrooms with ensuites
and 1 bedroom with its own
bathroom.

Both floors have brand new kitchens
and living areas 1 per floor!

This property can be secured for just
a £400 deposit!!

All our students benefit from top level
contents insurance including
covering all your gadgets inside the
property. What is even better is that
if you choose Mighty Student Living
you will also get other benefits such
as the 'Mighty Card' - our local
student discount card and entry to
our competitions. To keep up to date
with our latest giveaways, quality
student houses and offers make
sure to follow us on our Facebook,
Twitter & Instagram page.

Give us a call today on 01524
544222 and we can schedule a
viewing for you. We can also show
you around 2 other properties we
recommend on each viewing so you
can have some peace of mind that
you have landed the perfect house
for next year!

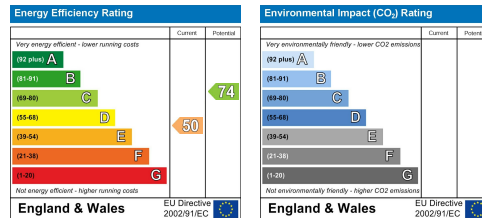

Ground Floor

Approx. 132.7 sq. metres (1428.2 sq. feet)

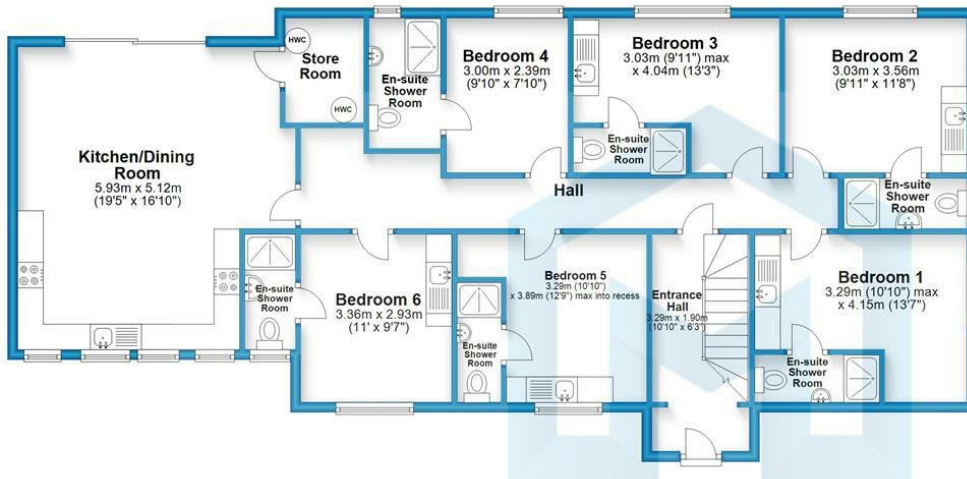

First Floor

Approx. 98.6 sq. metres (1061.3 sq. feet)

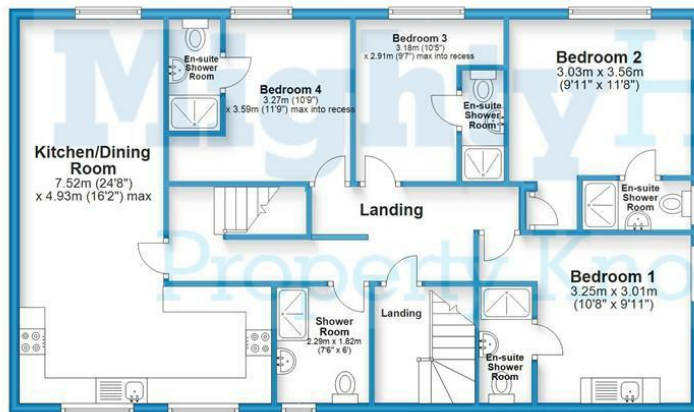

Total area: approx. 255.9 sq. metres (2754.1 sq. feet)

This floor plan is for illustrative purposes only and is not to scale. Where measurements are shown they are approximate and should not be relied on. No liability is accepted in respect to consequential loss arising from the use of this plan.
Plan produced using PlanUp.

Bowerham Road, Lancaster

Second Floor

Approx. 24.6 sq. metres (264.5 sq. feet)

